

4G EurPra/Wonpro2 Power Strip Features

After 30 Years – The New Revolution

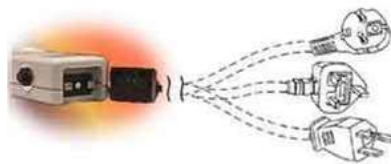
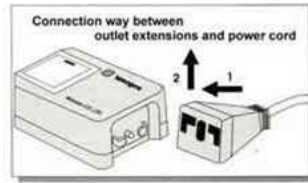

1. 5 Year Warranty Under Normal Usage

Using Hammer to Break 4G Power Strips Apart is Not Covered – Truly Unbreakable

2. Extremely Fire Resistant – Burn Test

2G WES4.5 – 15 Seconds: Caught Fire, 3 Minutes: Burned to Ashes.

4G WES.eT – 30 Seconds: Caught Fire, Minutes: Fire contained at the Direct Point of Contact.

3. 1,050 Joules Surge Protection on an Intelligent IC Boards

With MOV LED light and Ground LED light, and Fuse to prevent MOV Explosion.

Only Universal Power Strip built the right way.

4. Detachable / InterChangeable Power Cord

Support WSR-WSP connectors and IEC C14-C13 Connectors

- **WSR Connector** – Support up to 20 Amp cord (limited by 16 Amp Reset Switch). Vertically Slide in, horizontally can't be pulled apart, work like Direct Wired.
- **IEC C13 Connector** - IEC standards support 10 Amp, good for international travelers.

5. German/French/Schuko Grounding: 20 Years Innovation Patent, One and Only

The ONLY universal power strip that CAN keep German/French/Schuko Grounding when used with Continental Euro Plug

6. Patented New Innovation of Slide-In Safety Shutters

Slide-In New Technology (not “Slide-Out”): 20% reduction in width, less wasted Space

7. Double Pole Reset Switch to provide real “OFF” Function

Double Pole Switch cut off **both** L-Wire and N-Wire. When it is turned Off, it is “**OFF**”

Single Pole Switch only cut off electricity only on the Live Wire.

But, there is no international standard for the L-Pole and N-Pole locations.

The L-Wire can be on the right or on the left depending on the country.

The **US** and most **European** countries have N-L on the **opposite side**.

Germany engineers completely ignored the N-L reverse issue:

They allow a German plug to be inserted into the socket in either direction.

That is, wherever German/French socket is used, with a “single pole switch”,

50% of the time you can't turn off the power strip!

That is, the “OFF” function is either 50% FAKE or 100% FAKE!!

4G EurPra/Wonpro2 Power Strip Features

8. Special Designed Brackets to Secure 4G Power Strip on Medical Carts

They are designed to work with the 4G power strip's mounting holes, with extra long screw head to hold down power strip at a fixed location. The brackets support both "eA" and "eT" power strips.



9. Two Models

WES Model: Support **10 ~ 20 Amp**, WSR Power Cords: **1.0mm ~ 1.5mm** to meet AMP requirements

IEC Model: Follow IEC **10 Amp** standard (0.75mm cord), IEC C13 power cords upgraded to **1.0mm**



IEC.eA6
6 Outlet Universal Power Strip with Schuko Grounding
IEC C13 Power Cord Included



WES.eT6
6 Outlet Universal Power Strip with Schuko Grounding
Special Tandem Connector At Rear
(Power Cord is Separate)

Also Available: 11 Pages of Detailed Tech Doc in PDF