

EuraPra / Wonpro II – 4G Universal Power Strips

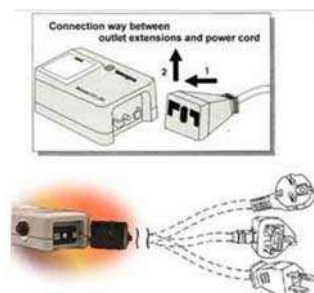

- 1. 5 Year Warranty Under Normal Usage**
Using Hammer to Break 4G Power Strips Apart is Not Covered – Truly Unbreakable
- 2. Extremely Fire Resistant – Burn Test**
2G **WES4.5** – 15 Seconds: Caught Fire, 3 Minutes: Burned to Ashes.
4G **WES.eT** – 30 Seconds: Caught Fire, Minutes: Fire contained at the Direct Point of Contact.
- 3. 1,050 Joules Surge Protection on an Intelligent IC Boards**
With MOV LED light and Ground LED light, and Fuse to prevent MOV Explosion.
Only Universal Power Strip built the right way.
- 4. Detachable / InterChangeable Power Cord**
Support WSR-WSP connectors and IEC C14-C13 Connectors
 - **WSR Connector** – Support up to 20 Amp cord (limited by 16 Amp Reset Switch). Vertically Slide in, horizontally can't be pulled apart, work like Direct Wired.
 - **IEC C13 Connector** - IEC standards support 10 Amp, good for international travelers.
- 5. German/French/Schuko Grounding: 20 Years Innovation Patent, One and Only**
The ONLY universal power strip that CAN keep German/French/Schuko Grounding when used with Continental Euro Plug
- 6. Patented New Innovation of Slide-In Safety Shutters**
Slide-In New Technology (not "Slide-Out): 20% reduction in width, less wasted Space
- 7. Double Pole Reset Switch to provide real "OFF" Function**
Double Pole Switch cut off **both** L-Wire and N-Wire. When it is turned Off, it is "**OFF**"
Single Pole Switch only cut off electricity only on the Live Wire.
But, there is no international standard for the L-Pole and N-Pole locations.
The L-Wire can be on the right or on the left depending on the country.
The **US** and most **European** countries have N-L on the **opposite side**.
Germany engineers completely ignored the N-L reverse issue:
They allow a German plug to be inserted into the socket in either direction.
That is, wherever German/French socket is used, with a "single pole switch",
50% of the time you can't turn off the power strip!
That is, the "OFF" function is either 50% FAKE or 100% FAKE!!
- 8. Special Designed Brackets to Secure 4G Power Strip on Medical Carts**
They are designed to work with the 4G power strip's mounting holes, with extra long screw head to hold down power strip at a fixed location. The brackets support both "eA" and "eT" power strips.





EURAPRA®

SASO CE

The NEW Wonpro II – **The Revolution after 25 Years**

EuraPra® : EurAsia Universal Powerstrips, Receptacles, Adapters

**First
Generation**



WE-4A6 - Discontinued 2012

**Second
Generation**



WES4.6 (tons of WES4.6 in Iraq) - Discontinued 2012

**Third
Generation**



WES.A6 - Discontinued 2015



WES.T6 (T6) - Available Now

**Fourth
Generation**



WES.eA6 (eA6) - Available Now



WES.eT6 (eT6) - Will Be Available Dec. 2015



EURAPRA®

SASO CE

The NEW *Wonpro II* - **The Revolution after 25 Years**

EuraPra® : EurAsia Universal Powerstrips, Receptacles, Adapters

eAx Series: Compact, Cannot Take UK Plugs Side By Side



eA3



eA4



eA5



eA6

eTx Series: UK Friendly - Can Take UK Plugs Side By Side



eT3



eT4



eT5



eT6



EURAPRA®

SASO CE

The **NEW Wonpro II** – **The Revolution after 25 Years**

EuraPra® : EurAsia Universal Powerstrips, Receptacles, Adapters

Tandem Universal Power Strips

Power Bars can be daisy chained as many times as you need



EuraPra®

Power Strip Burn Tests

Old & New Universal Power Strip



Old Power Strip



15 Sec: Caught Fire

Less Than 1 Min: Melting

2 Min: Entire Socket Melted

3 Min: BIG BIG FIRE, Strip Burned Into 2 Parts



New Power Strip



30 Sec: Caught Fire

1 Min: Small Fire at Point of Direct Contact

2 Min: Small Hole at Point of Direct Contact

3 Min: Bigger Hole at Point of Direct Contact



Why IEC Temperature Rise Test and Burn Test are so Important?



The above photo pictures are found on Google images:

1. The first one shows a power strip **MELTED** - This is why **IEC 60884 Temperature Rise Test** is so important
2. The second one show a power strip **ON FIRE** - This is why our **Burn Test** is so important

Near Perfect New Safety Shutters

1. Safety Shutters: To Prevent Potentially Deadly Electrical Shocks by 220V Electricity

We have a “**Near Perfect**” new safety shutters to protect against 220V electrical shocks. People think we push down to open safety shutters. But, the socket is right below the safety shutters. There is no way to push it down to open the socket – we push it away. That’s why our safety shutters are shaped as a slow. This is to “redirect” a vertically push down force to a horizontal force to push the safety shutter away to open the sockets right below them. All safety shutters are pushed to “**SLIDE OUT**”, which makes the power strips or plug adapters twice as big. We found a way to push the safety shutters to “**SLIDE IN**” and makes our universal power strips and plug adapters the most compact design in the whole world.

2. To “**SLIDE IN**”, the pressure point needs to be at the center of the safety shutters

This is not a problem for ALL plugs in the whole world, including the “curve end” UD plug. But, the “**FLAT end**” US plug used to be a HUGE problem. We’ve worked on this issue and make it a lot easier to insert through the safety shutter. Just in case you still have problem, then just insert your “**FLAT end**” US plug at 45 degree to make it easier to push the safety shutters to **SLIDE IN** and open the sockets.



It is "Perfect" because we even solved the Old Safety Shutters' inability to take US "flat end" plug.

US plug is so important. Any adapters that can't take US plug is not going to be widely accepted. The lack of solution leave the US market with ALL adapters without safety shutters like a third world country. To protect against serious accidental electrical shocks, we hope that US consumers will slowly discover how great EAS universal adapters are and choose them as the standard universal plug adapters. But, this transition will take some time. This is why we also offer the not so safe EAS universal plug adapters to ease this transition.

BREAKING NEWS:

We Have Just Solved This Last Annoying Problem in Last 30 Years!!

Our Net Production of EAS plug adapter will have the PERFECT Safety Shutters

4G WES.eA Series (the most Compact design, 1.6" socket spacing, Can't take UK plug side by side)

- 1. All of our new universal power strips will be CE certified and RoHS 2 certified.**
- 2. Update to use the new WAbc universal socket:**
 - 'b': It will take Brazil's new **Type N** BR-2 and BR-3 plugs
 - 'c': Correct the N-L reversal problem with the Swiss plug ("CH" is the two character country code for Switzerland)
- 3. Applied the new Schuko Ground Support to the new eAx-series**

This is our latest and greatest **Innovation** (20 years innovation patent pending)

Our universal power strips are the only one will not lose Schuko grounding when used with Schuko electrical devices.
- 4. Double-Pole Reset Switch**

Double the Thermal Surge Protection from 2,000 Watts to 4,000 Watts.

Double-Pole switch completely **cuts off electrical currents BOTH** on **Live** wire and on **Neutral** Wire. This guarantees the **"OFF"** function work 100% correctly in any country with any socket in the world.

Single-Pole switch only cuts off electrical current on the **Live** wire. This works on country specific power strips, but doesn't work on universal power strips – because the locations of the Live pole and the Neutral pole are very country specific.

 - US vs. China and "most" Europe: US Live and Neutral locations are at the opposite locations.
 - France vs. Czech: Use the "same" socket design, but Live and Neutral at the opposite locations.
 - German vs. the World: German engineers completely ignored the N-L Reverse problem 200 years ago. German socket has always allows a German plug to be inserted in any direction.

This means the universal power strip using a Single Pole switch will:

 - Lose the "OFF" function 100% when used in US, in Czech, and in some other countries.
 - Lose the "OFF" function 50% of the time when used in Germany.
 - This **fake** "OFF" function means after you "turn off" the power switch, it is still **HOT**. Any mistake can cause unexpected HUGE problems especially when it is 250V, 20 Amp. That is, "You are playing with real fire when you think there is no fire".

5. Replaced the R4 sockets with an Open Circuits

Build a power strip the right way, not the "lazy" way.

6. Applied the new Safety Shutters

This is our latest and greatest **Innovation** (20 years innovation patent pending).

The new **eA-series** power strips now meet the European Safety standards.

Fixed the very annoying "safety shutters" problem for "US Flat-End" plug

7. Add built-in Intelligent IC Board - the one and only universal power strip to use an IC Board

Our universal power strips are the only one with **built-in IC board** to protect MOV surge protection and to support LED lights indicators.

8. Add a Ground LED light, a MOV LED light - now it is an intelligent universal power strip!

Enable you to tell if the MOV is still working (not burned out by a surge yet). If the MOV surge protection is burned out, you have the option to decide to continue to use this power strip or to throw them away - in the old model, you have no way to tell if the MOV is burned out or not.

9. Increase MOV surge protection from 450 Joules to 1,050 Joules - on IC Board

We are the pioneer to add MOV surge protection to universal power strips - and we do it the right way!

To prevent "**MOV Explosion**", we have an extra fuse on our IC Board to protect our MOVs.

Adding MOV to the open circuit, not on an IC Board, actually adds more **Hazards** to a power strip - "MOV Explosion" can start a big fire.

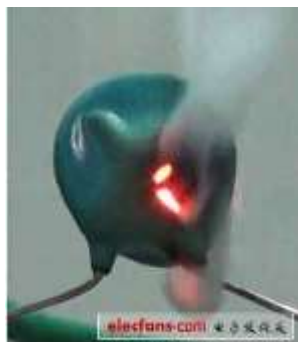

Surge: 600V 5A

10. Add 4-outlet eA4 and 5-outlet eA5 to complete this series

This was a great decision. Warner Bros loved our 4-outlet eA4 model; they bought thousands of **eA4** with various country specific cords right after they saw our pre-production samples. Clearly there is a large demand for 4-outlet and 5-outlet **eA** power strips.

11. Use the highest quality material

Upgrade the plastic to the highest quality **Phosphorus Copper** to offer the highest conductivity.

Upgrade the plastic to the highest quality **Non-Flaming "PC"**, with twice the "impact strength" of "ABS". The report says "PC" is better than "ABS" in every aspect except pricing - "PC" cost a lot more.

12. WSR Connector

Vertically slide up, horizontally can't be pulled apart. After connected, this "detachable-cord" power strip works and feels like "fixed-cord" power strip. Can support cords up to 20 Amp.

IEC C14 version also available, but it can be pulled apart horizontally, and only support 10 Amp.

The IEC version is specially designed for international traveller with low amperage devices.

WES.eA6

**6 Outlet Universal Power Strip with Schuko Grounding
(Separate Exchangeable Power Cord Design)**

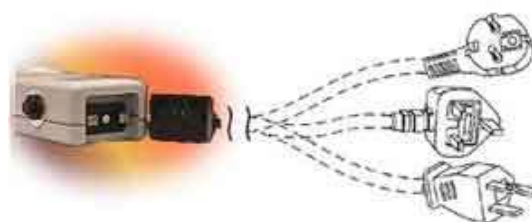
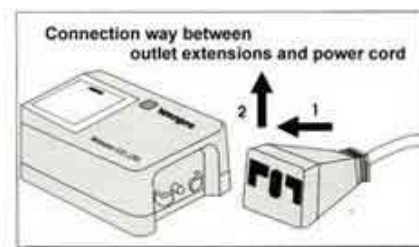

Surge: 600V 5A



Intelligent IC board controls LED Lights and with fuse to prevent MOV explosion.

4G **WES.eT** Series("eT Series "the UK Friendly design, 2.0" socket spacing, Can take UK plug side by side

1. **eT** series have **ALL the Enhancements** implemented on **eA** series!
2. Applied the **new Safety Shutters** to the **eT** series
The old BIG safety shutter dictated the old **T** series of power strips and ALL "Generic" Universal Power Strips to be **very WIDE**, very BIG: at least **65 mm** or 2.56 inches. With this completely redesigned **new Safety Shutters**, the width of the new **eT**-series of power strips are only **54 mm** or 2.126 inches, close to **20% of Reduction in Width**. That is, **eT** is the world's most compact universal power strip but still meeting the UK power strip's width requirement.
3. **WES.T6** and **WES.eT6** will come with a built-in "**Tandem connector**" at the end
Yes, you will get the "daisy-chain" feature for free.



Intelligent IC board controls LED Lights and with fuse to prevent MOV explosion.

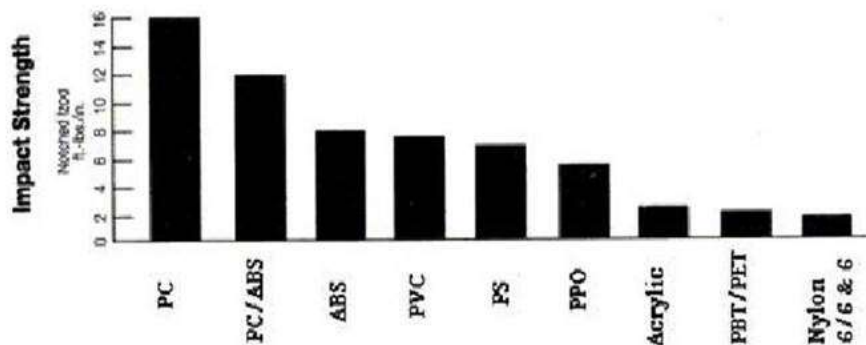

High Quality PC is what makes EuraPra Products so extremely Fire Resistant.



New IEC320-C14 Connector Available



EuraPra / Wonpro II Patented Next Gen 4G Universal Power Strip Enhancements

